

Data Sheet MTH/380

Type MTH/380

Product Reference	S.W.L.(kN)**	Width (W)	Height (H)	Box Qty.
MTH/380/38	14.52	38mm	171mm	50
MTH/380/44	14.52	44mm	168mm	50
MTH/380/50	15.79	50mm	165mm	50
MTH/380/63	17.18	63mm	158mm	50
MTH/380/75	14.84	75mm	152mm	50
MTH/380/88	14.84	88mm	146mm	50
MTH/380/100	10.00	100mm	140mm	50

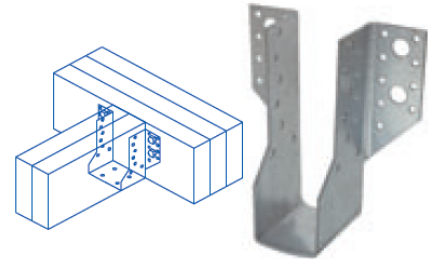

Special non-standard widths available to order.
**Safe working load when fully nailed & bolted.

For use in heavy duty applications such as multiple truss units, main trimmer joists, purlin to beam connections or similar situations where unusually heavy loads occur. Manufactured from 2mm thick galvanised steel. Bolt hole to suit M12 fixing, nail holes 5mm diameter.

Produced from galvanised steel to BS EN 10346:2009 + G275 as standard. Use 30 x 3.75mm sheradised square twisted nails in all pre-punched holes, together with bolts in Multi Truss Hanger range where required. Stainless steel hangers are available to order. Bearing surface on all multi-truss hangers is 75mm.

