

## Timber Frame Tie

This product is specifically designed to secure an inner timber frame to an outer brick skin. The main property of these ties is that they can absorb substantial vertical movement between the brick and timber while still performing their structural function.

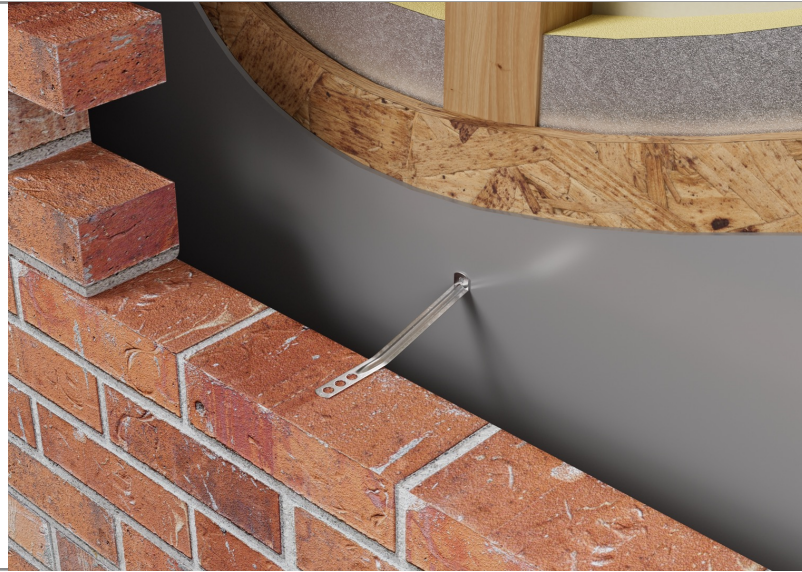

## Product

### V61 Timber Frame Tie

Stainless steel masonry-timber tie for 50-100mm cavities in up to 4 storey timber frame buildings. Accommodates vertical movement. Tested as type B (sound) and type 6 (strength) to BS EN 845-1. Supplied complete with 50mm x 3.35mm Stainless Steel Annular Ring Nails. Also available with 50mm x 4.0mm Stainless Steel Screws for SIPS panels.

## Test Results

V61 Timber Frame Tie	125mm (50mm cavity)	150mm (75mm cavity)	175mm (100mm cavity)
Tensile Load (As Received) Timber End	<b>1160N</b>	<b>1190N</b>	<b>1010N</b>
Compression Load (As Received) Timber End	<b>540N</b>	<b>440N</b>	<b>400N</b>
Tensile Load (24mm Movement) Timber End	<b>1010N</b>	<b>1230N</b>	<b>1140N</b>
Compressive Load (24mm Movement) Timber End	<b>560N</b>	<b>780N</b>	<b>400N</b>
Tensile Load Mortar End	<b>1060N</b>	<b>1090N</b>	<b>960N</b>
Compressive Load Mortar End	<b>480N</b>	<b>450N</b>	<b>400N</b>

### Safety Precautions

V61 Timber Frame Ties are manufactured from sheared plate and strip so may contain sharp edges. Suitable personal protection should always be used when handling/installing these products.