

## Sliding Anchor Systems

A range of heavy duty (welded) and light duty (bent and/or twisted) stems. Available in standard stem lengths, heads sizes and hole configurations with other options available on request. This range of products secure cavity walls to overhead structures, whilst accommodating vertical movement. Used in conjunction with one or two way sliding ties (ordered separately).

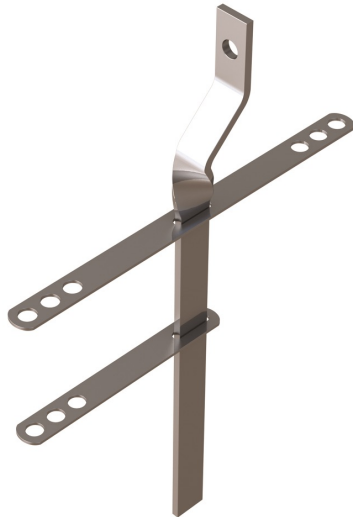

### Product

#### TFS Twisted F Stem

Used as a side fixed head restraint. Light Duty, and stepped to bring into the centre of cavity.

Hole size standard 12mm to suit M10 expansion bolts or M10 head bolt.

Design load resistant dependant on upper tie being a maximum of 75mm down from head

Sizes:	300mm	500mm
	350mm	550mm
	400mm	600mm
	450mm	

### Installation

Tightening Torque:	
M8 M.D. Anchor	<b>15Nm</b>
M8 Isolated setscrew	<b>14Nm</b>
M8 H.S.M. Bolt	<b>25Nm</b>

#### Safety Precautions

TFS Twisted F Stems are manufactured from sheared plate and strip so may contain sharp edges. Suitable personal protection should always be used when handling/installing these products.