

VS8D Dovetail Safety Tie With Drip

Data sheet

Issue Date:
March 2026

Channel Systems

These products allow vertical movement whilst offering horizontal restraint. The channel system tends to be face-fixed while the slot is usually cast into concrete. These systems may be used to overcome differences in coursing between masonry leaves.

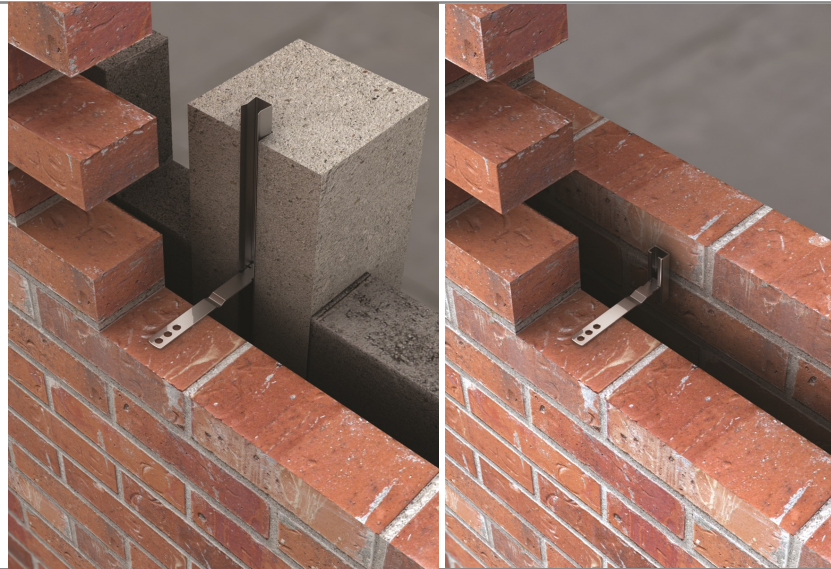
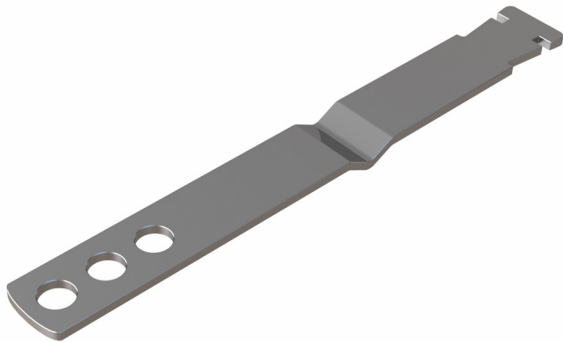

Product

VS8D Dovetail Safety Tie with Drip

A universal head enables this tie to be used with all V60 channel systems and V29 slot to restrain brickwork supplied with a drip to prevent the passage of moisture across the cavity. Drip positioned 90mm from safety end as standard.

Sizes:

100mm	200mm
125mm	225mm
150mm	250mm
175mm	

Performance

VS8D up to 125mm cavity	
Compressive Load Capacity	4896N
Tensile Load Capacity (cast in V29)	2960N
Tensile Load Capacity (surface in 28/15)	5284N
Tensile Load at Mortar End	5636N

VS8D up to 235mm cavity	
Compressive Load Capacity	1470N
Tensile Load Capacity (cast in V29)	2960N
Tensile Load Capacity (surface in 28/15)	5284N
Tensile Load at Mortar End	5636N

Safety Precautions

VS8D Dovetail Safety Ties with Drip are manufactured from sheared plate and strip so may contain sharp edges. Suitable personal protection should always be used when handling/installing these products.